

SYMBOL LEGEND

1 KITCHEN EQUIPMENT  
2 ITEM NUMBER

| KITCHEN EQUIPMENT SCHEDULE             |          |                 |   |
|--|----------|-----------------|---|
| EQUIP. ITEM #                          | QUANTITY | SUPPLIED BY     | DESCRIPTION   |
| ITEM #                                 | QTY      | MANUFACTURER    | DESC  |
| DRIVE THRU COOK LINE EQUIPMENT         |          |                 |   |
| 1                                      | 1        | NOT USED        |   |
| 2                                      | 1        | KC              | STAND - STAINLESS STEEL FAB   |
| 3                                      | 1        | KC              | GRIDDLE W/STAND - WULCAN 48"  |
| 4                                      | 1        | KC              | BUN TOASTER - APW W/ CUSTOM STAND & HOT WELL  |
| 5                                      | 1        | NOT USED        |   |
| 6                                      | 1        | KC              | ISLAND SANDWICH MAKE-UP TABLE W/ HEATED TOP   |
| 7                                      | 1        | KC              | DROP-IN REFRIGERATED COLD PAN - ATLAS   |
| 8                                      | 2        | KC              | GRAYEY WARMERS - APW COUNTER TOP  |
| 9                                      | 1        | KC              | OVERSHELF ASSEMBLY  |
| 10                                     | 7        | KC              | WASTE RECEPTACLE  |
| 11                                     | 1        | KC              | TO-GO BAGGING TABLE W/HEATED TOP  |
| 12                                     | 1        | NOT USED        |   |
| 13                                     | 1        | KC              | CONDIMENT BIN STAND   |
| 14                                     | 1        | KC              | ISLAND EXHAUST HOOD - CAPTIVE-AIRE ND-2-PSP, TYPE I   |
| 15                                     | 1        | KC              | REACH-IN REFRIGERATOR - TRUE - HALF DOORS   |
| 16                                     | 1        | KC              | MICROWAVE - PANASONIC NE-1064   |
| 17                                     | 1        | IC              | ICE MAKER W/BIN - MANTOWOC # 10-906C/B-579  |
| 18                                     | 1        | KC              | STAINLESS STEEL PASS OVER SHELF & WALL PANELING   |
| 19                                     | 1        | KC              | CHARCOAL FRIED BROILER - AZTEC #ST-48   |
| DRIVE THRU DRINKS                      |          |                 |   |
| 20                                     | 1        | IC              | ICED TEA BREWER & (4) DISPENSERS  |
| 21                                     | 1        | KC              | COFFEE CUP / LID HOLDER (NOT SHOWN)   |
| 22                                     | 1        | IC              | SATELLITE COFFEE BREWER W/4 DISPENSERS  |
| 23                                     | 1        | KC              | UNDER COUNTER "TRUE" REFRIGERATOR   |
| 24                                     | 1        | IC              | SODA/ICE DISPENSER - BY OTHERS  |
| 24A                                    | 1        | IC              | ICE MAKER   |
| 25                                     | 1        | IC              | SHAKE MACHINE-TAYLOR # 441 W/ FLASH BLENDER ADDED   |
| 26                                     | 1        | IC              | 2 BARREL ICE TRAY FRYER FACTORY 127A MACHINE-COUNTER TOP MODEL FOR LEMONADE AND LIQUIDS FLAVORS |
| 27                                     | 1        | KC              | 6'-0" X 2'-0" STAINLESS STEEL WORK TABLE W/ SHELF BELOW   |
| 28                                     | 1        | IC              | SYRUP LINES FROM ABOVE CEILING  |
| 29                                     | 2        | KC              | 30" X 48" BEVERAGE COUNTERS W/OVERSHELF   |
| MAIN EQUIPMENT - DINING ROOM COOK LINE |          |                 |   |
| 30                                     | 1        | KC              | 2-BURNER HOT PLATE - WULCAN #VCRH12   |
| 31                                     | 1        | KC              | GRIDDLE W/STAND - WULCAN #936-RX WITH #STAND/C48  |
| 32                                     | 1        | KC              | BUN TOASTER - APW W/ CUSTOM STAND & HOT WELL  |
| 33                                     | 1        | KC              | STAND - STAINLESS STEEL FAB   |
| 34                                     | 1        | NOT USED        |   |
| 35                                     | 2        | KC              | HOLDING BINS - PRINCE CASTLE #08B2PT-30 PASS THRU   |
| 36                                     | 1        | NOT USED        |   |
| 37                                     | 1        | KC              | ANSUL AUTOMAN PROTECTION SYSTEM   |
| 38                                     | 1        | NUMBER NOT USED |   |
| 39                                     | 2        | KC              | SHELVING UNITS 18 X 60, 4- TIER   |
| 40                                     | 2        | KC              | REACH-IN REFRIGERATOR - TRUE - HALF DOORS   |
| 41                                     | 1        | KC              | CHARCOAL FRIED BROILER - AZTEC #ST-48   |
| FRY STATION AREA AT DRIVE THRU         |          |                 |   |
| 42                                     | 1        | KC              | UNDER COUNTER FREEZER - TRAUlsen #ULT32-R   |
| 42A                                    | 1        | KC              | HEATED DUMP STATION - MARSHALL AIR #RRSC  |
| 43                                     | 5        | KC              | FRYERS - PITCO MODEL 405  |
| 44                                     | 1        | KC              | STAINLESS STEEL EXHAUST ENCLOSURE   |
| 45                                     | 1        | KC              | EXHAUST HOOD BACK SHELF - CAPTIVE AIRE 1927EX-BS, TYPE 1  |
| 46                                     | 1        | KC              | FRY DUMP STATION - MARSHALL AIR RRS-42LT  |
| 47                                     | 1        | KC              | 2' X 4' STAINLESS STEEL CASH REGISTER STAND W/ SHELF BELOW                                      |
| 48                                     | 1        | KC              | FRYER GREASE FILTER - PITCO P14   |
| 49                                     | 1        | KC              | REFRIGERATED BREADING STATION CONTINENTAL #SW36-12M   |

| KITCHEN EQUIPMENT SCHEDULE CONTINUED |          |                 |   |
|--------------------------------------|----------|-----------------|---|
| EQUIP. ITEM #                        | QUANTITY | SUPPLIED BY     | DESCRIPTION   |
| ITEM #                               | QTY      | MANUFACTURER    | DESC  |
| PREP AREA EQUIPMENT                  |          |                 |   |
| 50                                   | 1        | KC              | PREP TABLE W/SINK & S.S. UNDERSHELF                                       |
| 51                                   | 1        | KC              | 3-COMPARTMENT S.S. SINK W/FAUCETS - ADVANCE #94-3-54-24RL                 |
| 52                                   | 1        | KC              | UTENSIL RACK - ADVANC #9W-96  |
| 53                                   | 1        | KC              | WASTE RECEPTACLE  |
| 54                                   | 2        | KC              | SHELVING UNITS (1) 24 X 60 4-TIER   |
| 55                                   | 1        | KC              | STAINLESS STEEL WALL SHELF  |
| 56                                   | 1        | IC              | WASTE RECEPTACLE  |
| 57                                   | 1        | KC              | CONVECTION OVEN   |
| 58                                   | 1        | KC              | TYPE II EXHAUST HOOD  |
| 59                                   | 1        | HV              | EXHAUST FAN & CURB  |
| SYRUP STATION AREA EQUIPMENT         |          |                 |   |
| 60                                   | 1        | IC              | SODA SYSTEM - MULTIPLEX   |
| 61                                   | 1        | IC              | SODA SYSTEM BIB RACK - CORNELIUS # 384WB                                  |
| 62                                   | 1        | IC              | FRYER OIL RECEPTOR  |
| 63                                   | 1        | IC              | SODA SYSTEM AIR COMPRESSOR (AT BACK BY ELECTRICAL)                        |
| 64                                   | 1        | IC              | BULK CO <sup>2</sup> TANK (AT BACK BY ELECTRICAL)                         |
| 65                                   | 1        | IC              | SYRUP LINES FROM ABOVE CEILING  |
| 66                                   | 1        | IC              | ICE MAKER   |
| 67                                   | 1        | IC              | ICE MAKER   |
| 68                                   | 1        | IC              | ICE MAKER   |
| 69                                   | 1        | IC              | ICE MAKER   |
| SELF SERVE DRINK STATION EQUIPMENT   |          |                 |   |
| 70                                   | 1        | KC              | SELF SERVE BEVERAGE COUNTER   |
| 71                                   | 1        | KC              | COFFEE CUP LID HOLDER   |
| 72                                   | 2        | IC              | SATELLITE COFFEE DISPENSERS   |
| 73                                   | 2        | IC              | TEA DISPENSERS - BY OTHERS  |
| 74                                   | 1        | KC              | CONDIMENT BINS FOR SALT, PEPPER, SUGAR, NAPKINS, PLASTIC UTENSILS         |
| 75                                   | 1        | IC              | SODA / ICE DISPENSER  |
| 76                                   | 1        | IC              | SYRUP LINES FROM ABOVE CEILING  |
| 77                                   | 1        | IC              | ICE MAKER   |
| 78                                   | 1        | IC              | ICE MAKER   |
| 79                                   | 1        | IC              | ICE MAKER   |
| STORAGE SHELVING                     |          |                 |   |
| 80                                   | 2        | KC              | 24" X 36" FOUR TIER FIXED 72" HIGH  |
| 81                                   | 4        | KC              | 24" X 60" FOUR TIER FIXED 72" HIGH  |
| 82                                   | 2        | IC              | PLYWOOD PAINTED SHELVES FOR OFFICE (18" DEEP)                             |
| 83                                   | 1        | KC              | 24" X 42" FOUR TIER FIXED 72" HIGH  |
| 84                                   | 1        | IC              | 24" X 36" CHARCOAL CART W/ WHEELS   |
| 85                                   | 5        | KC              | 24" X 48" FOUR TIER FIXED 72" HIGH  |
| 86                                   | 4        | IC              | BUN RACK  |
| 87                                   | 1        | IC              | ICE MAKER W/BIN - MANTOWOC # 10-906C/B-579                                |
| 88                                   | 1        | NUMBER NOT USED |   |
| 89                                   | 1        | NUMBER NOT USED |   |
| OTHER EQUIPMENT                      |          |                 |   |
| 90                                   | 2        | IC              | HAND SINK - ADVANCE #7-PS-80  |
| 91                                   | 1        | IC              | WATER HEATER, PROVIDED BY G.C.  |
| 92                                   | 1        | IC              | 24" X 24" RECESSED S/S MOP SINK   |
| 93                                   | 2        | KC              | MOP RACK STORAGE  |
| 94                                   | 1        | IC              | PLASTIC LAMINATE SHELF ABOVE MOP SINK                                     |
| 95                                   | 2        | IC              | BUILT-IN DESK & COUNTER AT DRIVE THRU MOP # 1 & OFFICE - PROVIDED BY G.C. |
| 96                                   | 1        | IC              | DESK CHAIR W/ CASTERS   |
| 97                                   | 1        | IC              | 4-DRAWER FILE CABINET   |
| 98                                   | 1        | IC              | SAFE  |
| 99                                   | 1        | KC              | LOW TEMP PATTY REFRIGERATOR   |
| 100                                  | 2        | IC              | #10 LB. FIRE EXTINGUISHER - ABC W/ CLASSIFICATION 1-0-B-C                 |
| 101                                  | 1        | IC              | #6 LB. FIRE EXTINGUISHER - ABC W/ CLASSIFICATION 2-A-10-B-C               |
| 102                                  | 4        | IC              | TRASH CONTAINERS AT DINING ROOM   |
| 103                                  | 8        | IC              | OVERHEAD MONITORS AT KITCHEN (TO BE LOCATED BY OPERATIONS)                |
| 104                                  | 7        | IC              | CASH REGISTERS  |
| 105                                  | 1        | IC              | SURFACE MOUNTED MENU BOARD  |
| 106                                  | 1        | IC              | WALK-IN COOLER/FREEZER  |
| 107                                  | 16       | KC              | CORNER GUARDS   |
| 108                                  | 4        | KC              | STORE ROOM SHELVING   |
| 109                                  | 1        | IC              | HME   |
| 109A                                 | 12       | KC              | 18" X 42" THREE TIER FIXED 60" HIGH SHELVING UNITS                        |
| 109B                                 | 1        | KC              | TRASH CART - RUBBERMAID #RW11-88  |
| DINING ROOM EQUIPMENT                |          |                 |   |
| 110                                  | 5        | IC              | DINER WALLS & HALF WALLS IN DINING ROOM (BY OWNER)                        |
| 111                                  | TBD      | IC              | TABLES, CHAIRS, BENCH & WOOD BOOTHS (BY OWNER)                            |
| 112                                  | TBD      | IC              | DECOR, PHOTOS, MURALS & ADVERTISEMENTS (TO BE DETERMINED BY OWNER)        |
| 113                                  | TBD      | IC              | BABY BOOSTER CHAIRS (BY OWNER)  |
| 114                                  | 2        | IC              | BABY CHANGING STATION (BY OWNER) INSTALL AT ADA HEIGHT                    |
| 115                                  | 2        | IC              | POP SIGN (POINT OF PURCHASE)  |

NOTE: ALL TOILET ACCESSORIES & BABY CHANGING STATION ARE BY OWNER AND INSTALLED BY GEN. CONTRACTOR.  
NOTE: ALL SHELVING TO BE COORDINATED W/ OWNER AND INSTALLED BY GENERAL CONTRACTOR.  
NOTE: ALL INTERIOR FLOOR, WALL & CEILING FINISHES TO BE SELECTED BY OWNER AND INSTALLED BY GENERAL CONTRACTOR.

| ABBREVIATIONS                  | NOTES  |
|--------------------------------|--|
| GC... GENERAL CONTRACTOR       | 1. ELECTRIC SERVICE SHALL BE 120/208 V., 3PH, UNLESS STATED OTHERWISE.<br>2. THE GENERAL CONTRACTOR SHALL VERIFY HIS RESPONSIBILITIES REGARDING EQUIPMENT INSTALLATION & EQUIPMENT PROVISIONS WITH THE KITCHEN MANUFACTURER.<br>3. THE SHADDED AREA INDICATES THE WALL & CEILING MOUNTED KITCHEN HOODS OVER COOKING AREAS.<br>4. THE SHADDED AREA INDICATES THE WALL & CEILING MOUNTED KITCHEN HOODS OVER COOKING AREAS. EXTEND HOOD 6" PAST HEATED EQUIPMENT BELOW. |
| HVAC... HVAC CONTRACTOR        |  |
| KC... KITCHEN CONTRACTOR       |  |
| PL... PLUMBING CONTRACTOR      |  |
| OW... OWNER                    |  |
| EC... ELECTRICAL CONTRACTOR    |  |
| FC... FIRE SAFETY CONTRACTOR   |  |
| RC... REFRIGERATION CONTRACTOR |  |
| TBD... TO BE DETERMINED        |  |

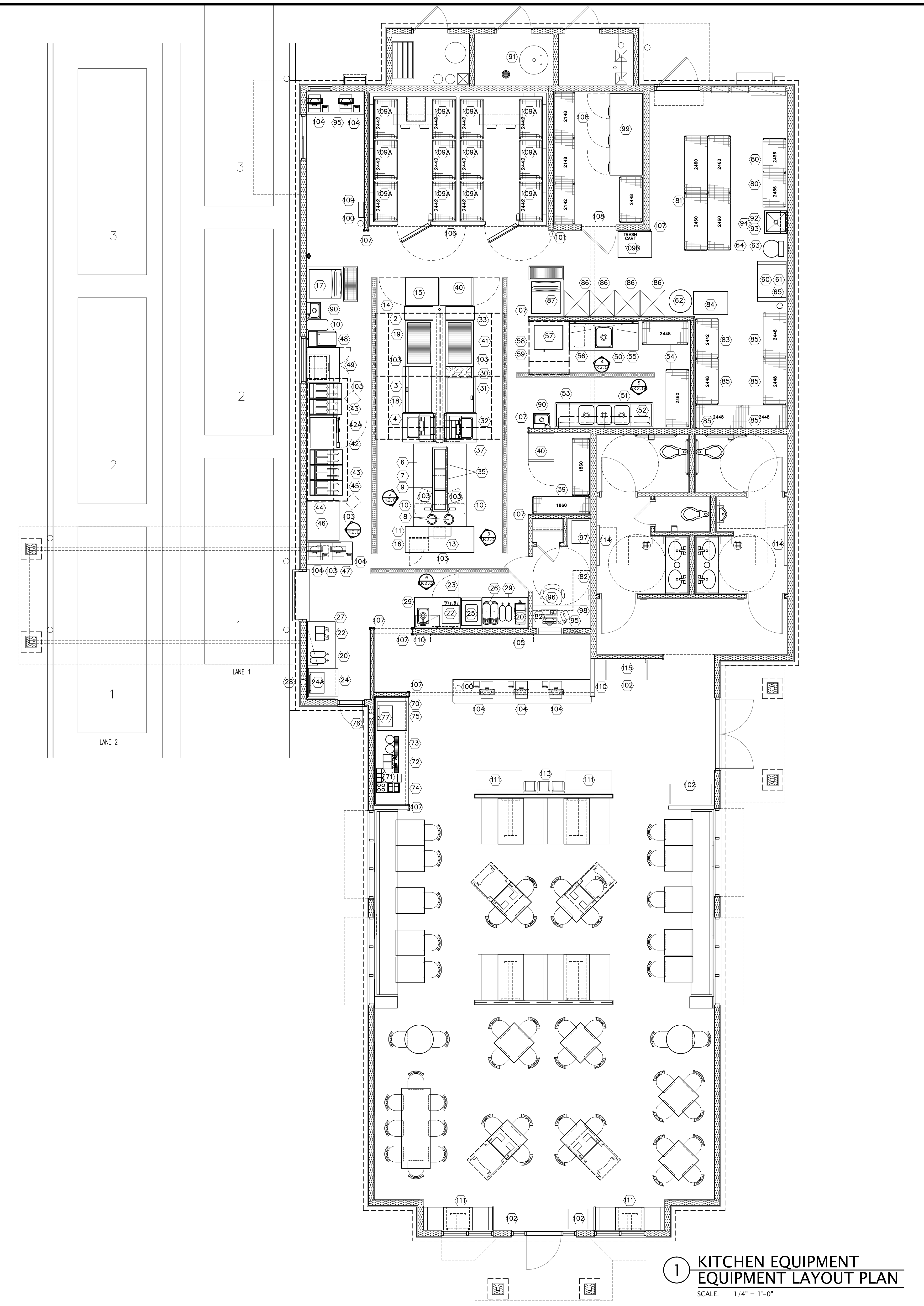
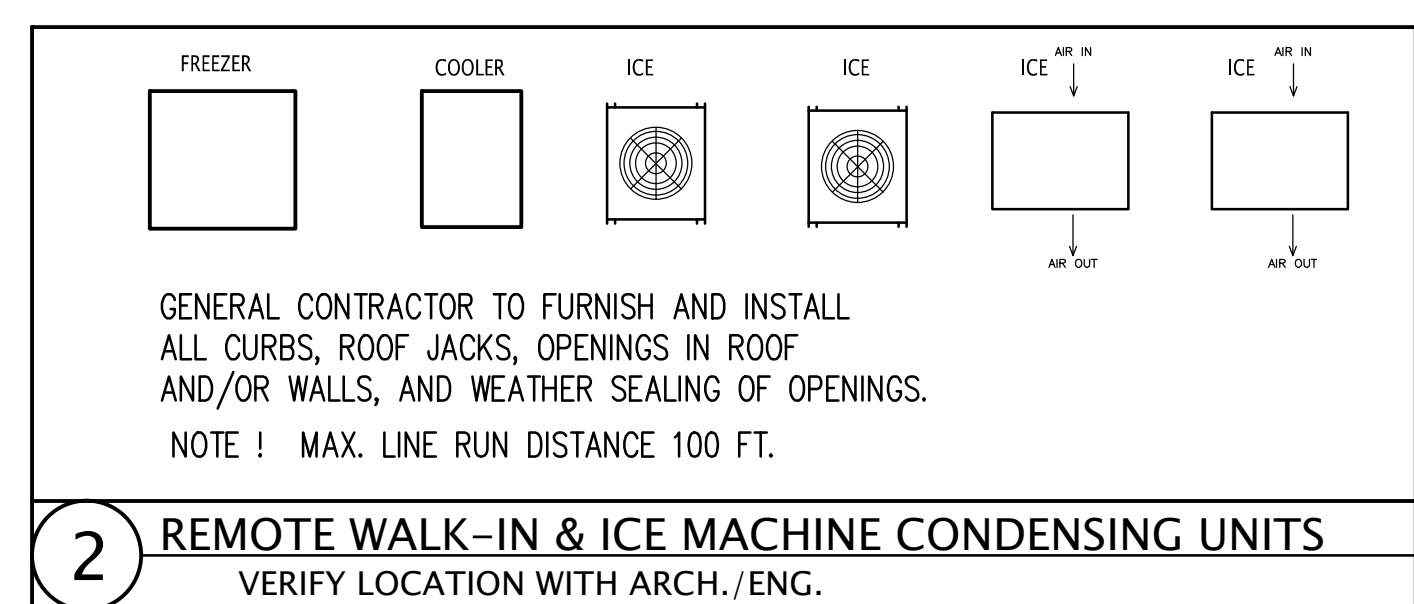

1 KITCHEN EQUIPMENT EQUIPMENT LAYOUT PLAN  
SCALE: 1/4" = 1'-0"

MORGAN SPEAR ASSOCIATES, INC. ARCHITECT  
 ARCHITECTS PLANNERS  
 225 S. CARANCAHUA STREET  
 CORPUS CHRISTI, TEXAS 78401  
 (361) 883-5588 PHONE (361) 883-9204 FAX

ARCHITECT'S PROJECT NUMBER  
 120928

C.S. Smith  
 CFSP

MISSION RESTAURANT SUPPLY  
 1126 St. Mary's - San Antonio, TX 78210  
 210-354-0600 FAX 210-334-3853 e-mail: clarence@missionst.com

Kitchen Equipment Layout Plan  
 FRONTIER BURGERS  
 PETRO CENTER / CROWN HILL @ 410  
 San Antonio, Texas 78254

Frontier Burgers  
 Kitchen Layout  
 REVISIONS:

DATE DRAWN: 09-22-2014  
 SHEET NO.  
 K1.0